

# Mitigating Two of The Biggest Crises Facing Our Planet – Climate & Housing

*Eco-Living Delivered,  
Anywhere*



With its new housing concept, NX-Cast plans to raise the bar in small space dwellings.

With the use of ELCEMITE, a new NX-Cast material, construction can now be resilient and cost-effective while being eco-friendly and sustainable.

Trade-named “the ELWOOD™”, our unique home design will deliver what’s needed and be engineered to ship and use anywhere in the world.

At its destination, the unit will easily unfold into a self-contained living area that is 2.5X its shipping size.

**For information on participating in The ELWOOD Project and to pre-order, please contact:**

**NX-Cast Innovations, 6099 Frank St., Mitchell, ON, Canada N0K 1N0 • (519) 274-2505 • [info@nxcast.ca](mailto:info@nxcast.ca)**

# What you should know about the problem and our key solution:

## Problem:

- To meet climate goals, we must drastically reduce the use of fossil fuels,
- Last year 40.5 billion tons of CO<sub>2</sub> were emitted; leading to life-changing heat waves, droughts, flooding, wildfires and devastating storms,
- Construction causes 40% of the world's climate pollution,
  - creates over 2 billion tonnes of waste annually,
  - consumes vast amounts of non-renewable resources,
- Exasperating this is; by 2030, 3 billion more people will need housing,
  - equates to building 96,000 new units every day for next 8 years,
- What we build and what we build with are killing our planet.



**Resistant to fire, wind, temperature, mold and decay .... our state-of-the-art solution can help address the housing problem, while providing a means to mitigate climate change.**

## Solution:

- Made with a whole new material that it is uniquely formulated to be kind to our planet. We call it ELCEMITE.
- Mitigates impact from construction by reducing weight, saving resources, cutting emissions while providing new possibilities for insulation and carbonization,
- Complete living space engineered to be cost-effective, aesthetically pleasing and environmentally correct,
- Units would be available in two sizes using the dimensions of the 6- or 12-meter, high cube shipping container,
- Built to withstand extreme environmental demands, units are well suited for shipping and use in remote locations,
- Designed to be built in a pre-fabrication factory, shipped to the end-user as a typical shipping container and setup on site using onboard mechanisms with no crane required,
- Includes deck area, cupboards, fridge, stove, washer/dryer, Murphy bed and solar panels with backup battery,
- Unit cost would not include shipping, site work, foundations, utilities and/or home servicing,
- Perfectly engineered to meet current trends to green living,
- Can be easily relocated by reversing delivery procedures.

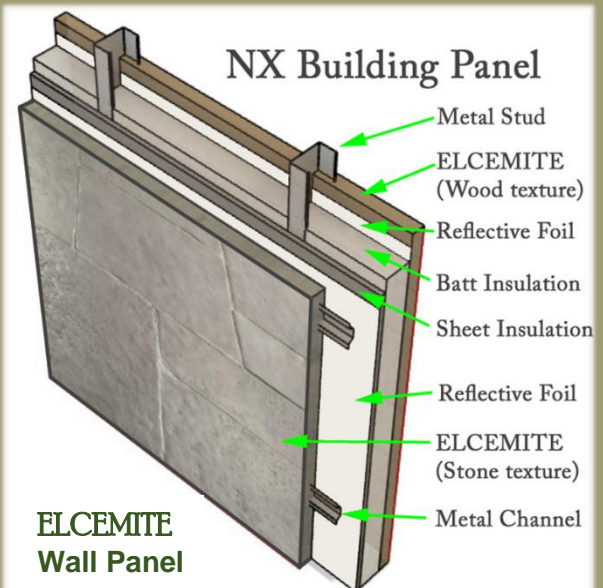

## ELCEMITE Unique

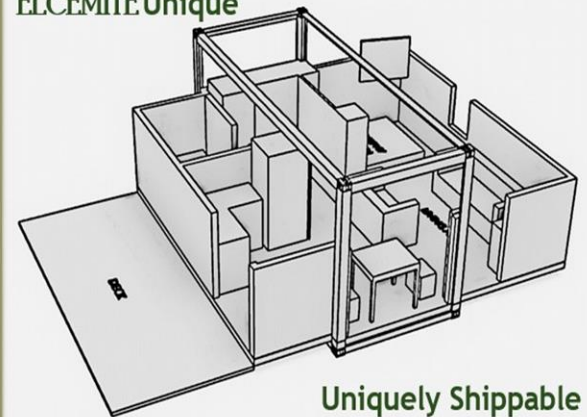

## Note to Reader:

To properly accommodate project support from the United States, NX-Cast 2023 will be incorporated as a Subchapter "C" corporation in the State of Delaware. This NX "sister" entity will have specific rights to IP.

NX-CAST Innovations is a NX licensed entity with specific rights to the ELCMITE technology and the NX product brands for the purpose of manufacturing, distribution, marketing and sales.

Copyright © 2023, NX-CAST Innovations. All rights reserved.